



ROYAL GOVERNMENT OF BHUTAN
CIVIL AVIATION DEPARTMENT

NOTE:
-ALL DIMENSIONS ARE IN MILLIMETERS UNLESS SPECIFIED OTHERWISE
-ALL RELATIVE LEVELS ARE IN METERS UNLESS SPECIFIED OTHERWISE
-ALL DIMENSIONS MEASURE UNFINISHED SURFACES UNLESS SPECIFIED OTHERWISE
-ALL DIMENSIONS ARE TO BE READ AND NOT SCALED OFF
-ANY DISCREPANCY IN DRAWING IS TO BE BROUGHT TO THE IMMEDIATE NO
THE CONSULTANTS/SUPERVISION TEAM
-MINOR ADJUSTMENTS NEED TO BE CARRIED OUT ON SITE TO MATCH WITH I
BUILDING

Legend

No.	Revision	Date

Client
Royal Government of Bhutan Civil Aviation Dep
Aviation Planners & Engineers
Leading Edge Aviation Planning Professionals
Civil Engineering Consultant
Gyaltshen Consultancy
Project Title

GELEPHU DOMESTIC AIRP
DESIGN & SUPERVISION

DESIGN OF SECURITY
QUARTERS.

Drawing Title

OFFICER'S RESIDENCE

DOOR DETAIL (D1)

Scale	1:20
Date	SEPTEMBER 1ST 2016
Drawn By	TSHEWANG GYELTSHEN
Design By	DINESH
Drawing Number	GEL AIRPORT OR DW09
LEAPP Project Code	----

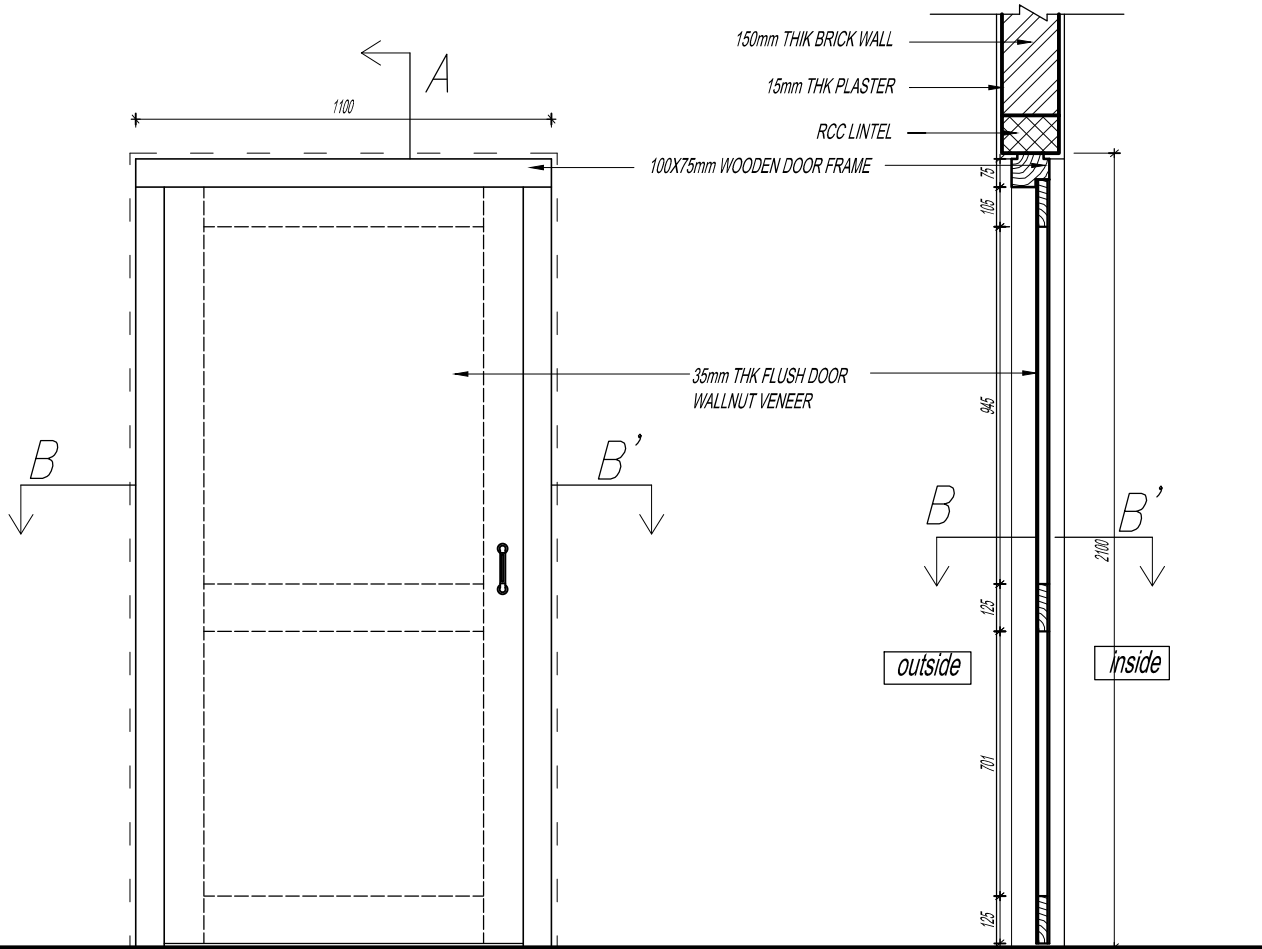

ELEVATION

SECTION AA'

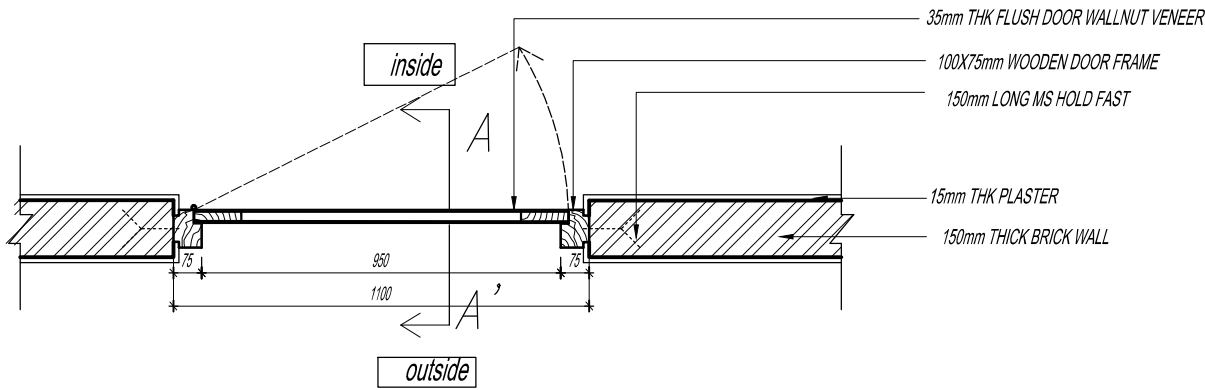

SECTION BB' (D1)

note:
-shutter to be provided with brass cylindrical lock at 900mm from F.F.lvl.
-shutter to be provided with 1 no. 150mm brass tower bolt at top.
-shutter to be provided with 3 nos 70mm brass hinges.
-each door frame to beprovided with 4 nos. of 150mm long MS hold fast.
-no tenon of the joints should be visible around the rebates.
-no nails shall be used on the joints.
-Use of timber dowels(not bamboo) is highly encouraged.

